

PREMIUM
SECURITY & HIGH
PERFORMANCE
DOORS

Janus Armoured Security and Fire Doors

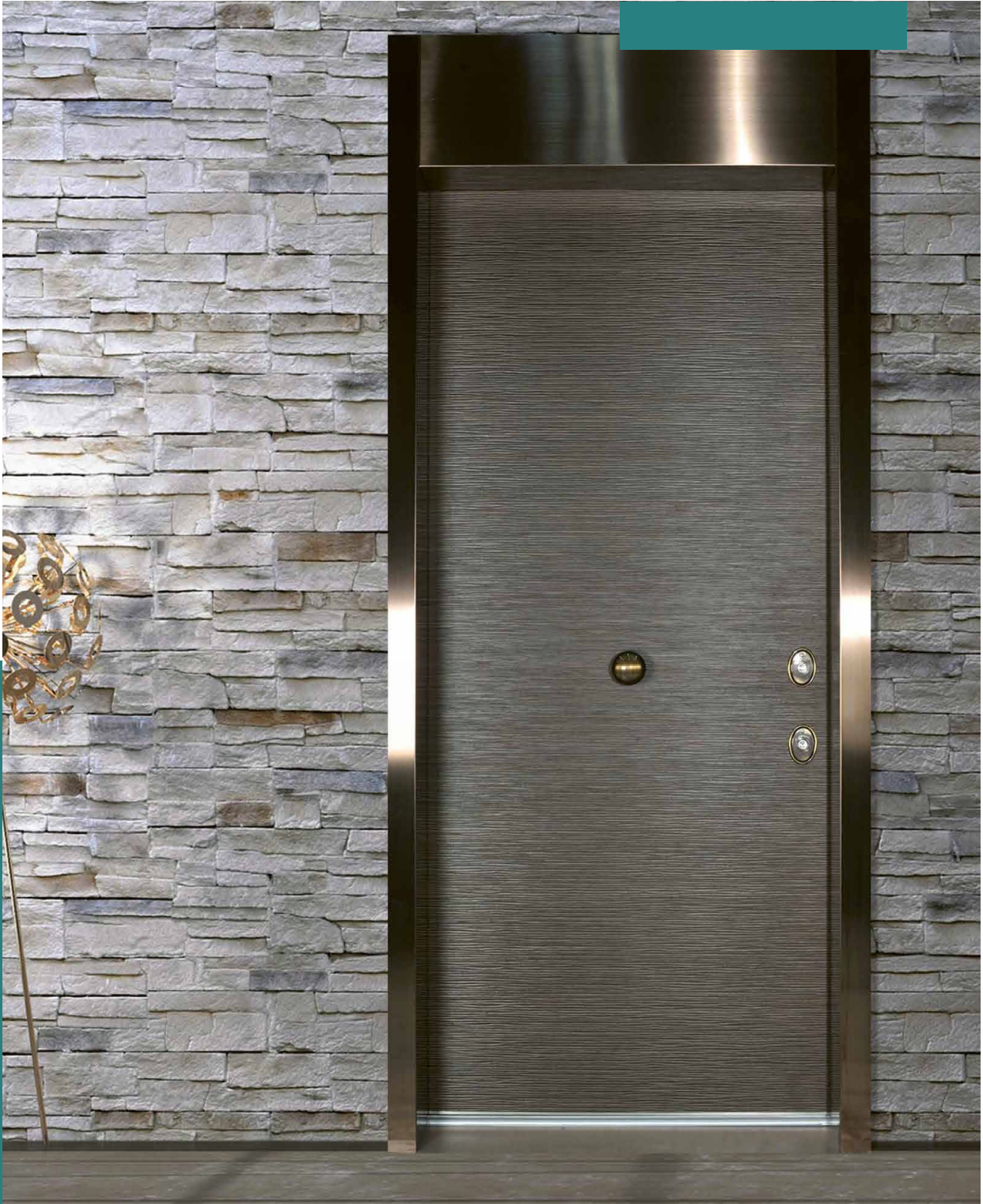

Basic Specifications

 **BURTON**
SECURITY

REFINING OUR VISION

What does protection mean for Burton Security?

All our armoured doors have been tested and certified in the laboratory to **ensure maximum protection and security from break-in attempts**. The ability to resist is measured with a combination of static and dynamic loads, and the simulation of burglary attempts implemented with different types of both manual and electric tools.



Burglar-proof security



Fire resistance



Thermal insulation



Sound insulation



Water tightness



Air tightness



Wind tightness



Longevity

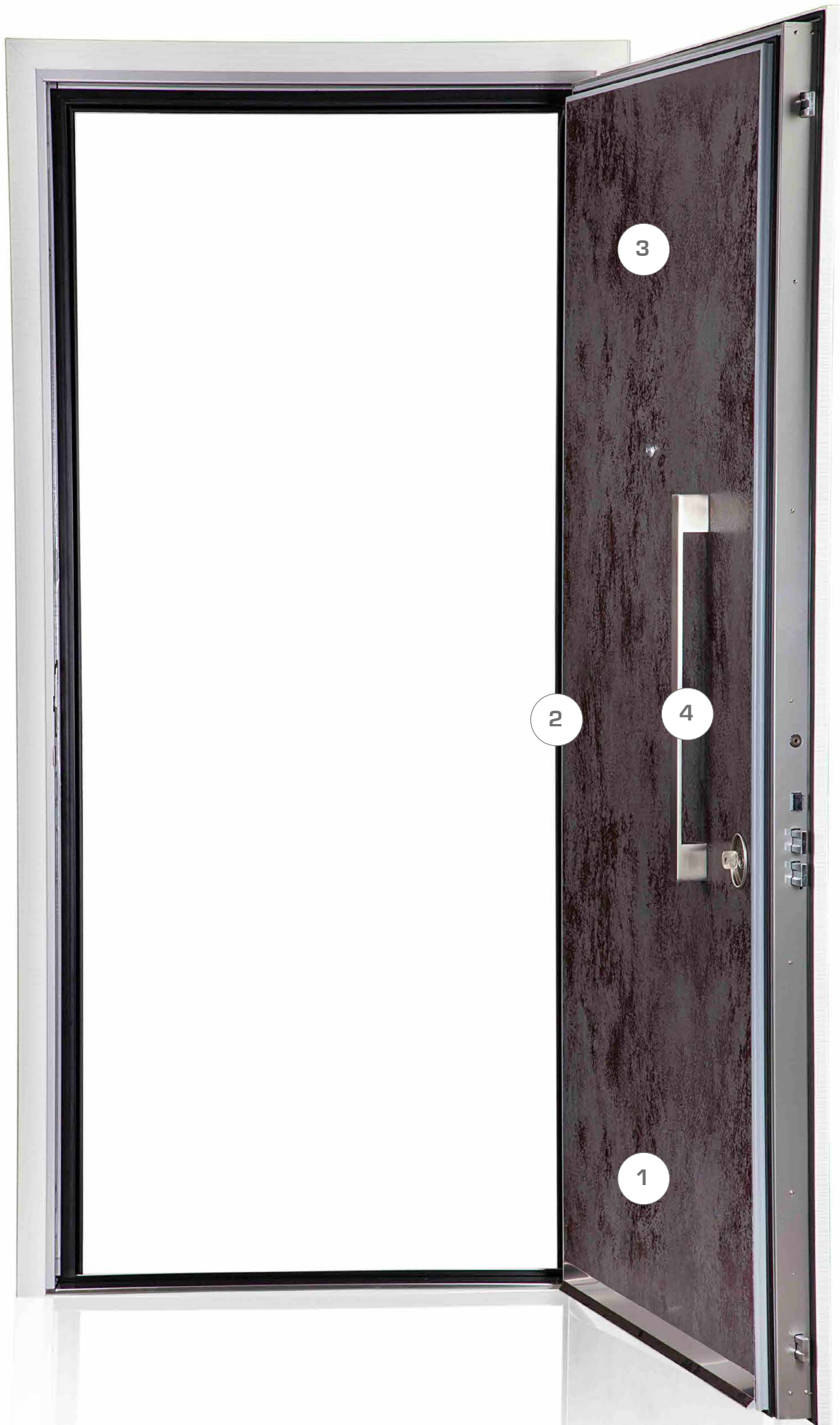

EMBOSSED DESIGNS*

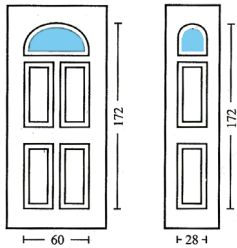

Algenib/K1

Algenib/KS1

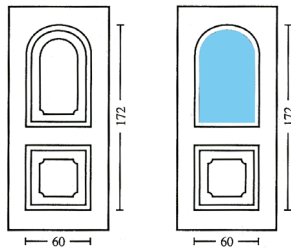

Ikaro/K

Ikaro/K1

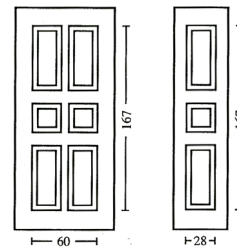

Eridano/K

Eridano/KS

- 1 We offer a variety of models according to the door location, security needs and performance requirements
- 2 We can supply a huge range of shapes and sizes including single leaf, double leaf, glazed panels, over panels, side panels and arched panels. We offer both inward and outward opening doors
- 3 We offer hundreds of finishes and colours in a choice or combination of wood, steel, aluminium mineral and ceramic panels. Each door we supply is made to order according to your requirements
- 4 We have a range of traditional and modern door hardware. Doors can be supplied with fixed or lever handles according to your needs



Aluminum F9



Polished brass



Design Options

If you have a specific request, please speak to us. We have a team of craftsmen based in Yorkshire who can design handmade and unique finishes to your door.



SAFETY AND PROTECTION

Class 3 – This describes the door's performance against burglary attempts. At level 3, testing is undertaken by applying static & dynamic loads as well as undertaking attacks using manual tools such as crowbar, screwdrivers, pliers, etc for a maximum test duration of 20 minutes.

Class 4 – This describes the door's performance against burglary attempts. At level 4, testing is undertaken by applying static & dynamic loads as well as undertaking attacks using manual and electrical tools such as hammer, chisel, axe, bolt cutters, electric drill, etc for a maximum test duration of 30 minutes. Its worth noting that a Class 4 door is at least twice as strong as a Class 3 door, making our Janus 4 & Gold models exceptional value.



FIRE RESISTANCE

The reference values are where E stands for Integrity and I stands for insulation.

The integrity test measures the spread of flame through the door.

The insulation test measures the temperature rise on the protected side of the door.

The number 30, 60, or 120 represents the duration of the test in minutes.

The number 1 or 2 describes two different test and pass criteria, with the number 1 being a more stringent test. Under EI 1 thermocouples for measuring the temperature rises are placed closer to the door edges. Additionally, the allowed temperature rise of the thermocouples placed on the door frame are 180oC rather than 360oC at EI 2. In both standards EI 1 & EI 2 the average temperature rise of 5 fixed thermocouples placed on the door leaf may not exceed 140oC.



ACOUSTIC ISOLATION

It is measured in db Rw and it is the capacity to prevent the passage of noise through the door (sound isolation). The higher the value in the display, the better the sound-isolating power. Its worth noting that this value doubles with each 2.7dB. As an example our Janus Gold with 46dB has twice the sound insulation of our Janus 3 with 43dB. Janus doors offer very high levels of sound insulation compared with the market average.



AIR TIGHTNESS

Air permeability is measured in classes from 0 to 4 which indicate the ability to prevent the passage of air through the door. The higher is the classification value, the better it will perform.



WIND TIGHTNESS

Wind resistance is measured in classes from 0 to 5 which indicate the increasing static resistance of the door to strong gusts of wind and even hurricanes. All our external Janus door have a minimum Class 4 meaning that they can withstand a pressure of 1000Pa or equivalent 150km/h and our top level Janus Gold & Platinum can withstand wind speeds of 180km/h.



THERMAL ISOLATION

Often referred to as a U value. The insulation for a complete door and framework is measured in (W / m²K) and it is the capacity to prevent the thermal exchange between two rooms separated by the door. The lower the number, the better the insulation.

The number 0 would mean that no heat is transferred at all. Our Janus range has industry leading U values, with the Gold & Platinum models suitable for use in Passivhaus schemes.



WATER PERMEABILITY

Water tightness is measured in classes from 0 to 9 and indicates the capacity to prevent the passage of pressure water through the reinforced gate door. The higher the classification value, the better the tightness capacity.



A photograph of a child's room. On the left, a white door is partially visible. In the foreground, there is a large teddy bear, a container of colorful building blocks, and some wooden toys. The background is a plain white wall.

Internal Armoured Doors.

9

Our internal armoured door is produced with the best materials, all tested and certified.

They can be perfectly integrated in buildings with style and convenience.

Ideal for apartments, offices and to secure individual rooms in your home.

A Janus Burton Security door embodies excellence when it seamlessly intertwines security and comfort.

Janus 3

Break-in resistance class 3 EN 1627/30

Acoustic insulation -43 dB Rw

Thermal insulation Ud = 1.3W/m²K

- Electrogalvanized** steel structure
- Thermal insulation** in compressed mineral wool
- Special high performance automatic doorstrip**
- External seal** on frame, **internal seal** on leaf
- Defender** in special steel class3 anti-pick rating
- Security lock** geared mechanism activating six bolts with self-centring rectangular latch bolt
- Hinges** 2 adjustables in 3 directions
- Fixed steel bolts** 3 with flat profile
- Wide-angle spyhole**
- Veneered or melamine** standard panels
- Handles** F9 finish aluminium
- External** casing strips in plastified sheet RAL 9006
- Frame** RAL 9006 or RAL 9010
- European cylinder** 1+3 keys, according to class WK3
- Subframe** 3D adjustable in 3 directions

Standard sizes: 80 to 90 x 200 to 210 cm
This model is available with different sizes from standard

OPTIONALS

- Security retainer
- Metal Hinge covers
- Internal casing strips
- External casing strips
- Cylinder with mastered system
- Double side key cylinder
- Kit Avantgarde electronic locking system with batteries
- Kit Avantgarde Plus electronic locking system with mains power
- Kit Avantgarde Pro electronic locking system with mains power & single action to escape Alarm sensor
- Boltwork position sensor
- Surface mounted & hidden door closer
- European cylinder 1+3 keys, according to class WK4

VARIATIONS

- Brass handles (polished, polished or satin chrome, bronze finish)
- Bullet resistance to FB4 & FB6

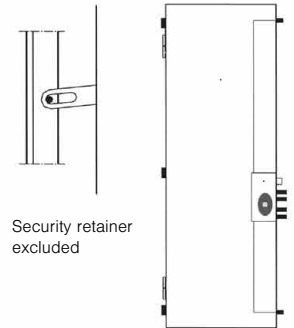

Height between 86 and handle 95 cm
compliant including Ministerial
Decree 236 of Id/06/1989
Door handle height 86-95cm

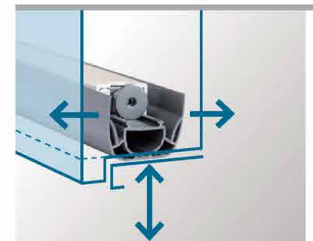

Draft excluder blade + possible stop

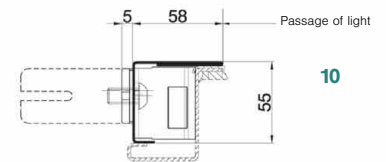

Hydraulic overhead door closer
3D subframe

Notes: the handles height is between 85 and 95 cm according to D.M.
236 14/06/1989

Janus 4

Break-in resistance class 4 EN 1627/30

Acoustic insulation -44,8 dB Rw

Thermal insulation Ud = 1.2W/m²K

Electrogalvanized steel structure

Thermal insulation in compressed mineral wool

Special high performance automatic doorstrip

External seal on frame, **internal seal** on leaf

Oval Defender in special steel class4 anti-pick rating

Security lock geared mechanism activating six bolts

with self-centring rectangular latch bolt

Hinges 2 adjustables in 3 directions with same handles finish

Fixed steel bolts 3 with flat profile

Wide-angle spyhole **Veneered or melamine** standard panels

Internal casing strips

External casing strips in plastified sheet RAL 9006

Brass handles (polished, polished or satin chrome, bronze finish)

Frame RAL 9006 or RAL 9010

European cylinder 1+3 keys, according to class WK3

Subframe 3D adjustable in 3 directions

Standard sizes: 80 to 90 x 200 to 210 cm

This model is available with different sizes from standard

OPTIONALS

Security retainer

Metal Hinge covers

Internal casing strips

External casing strips

Cylinder with mastered system

Double side key cylinder

Kit Avantgarde electronic locking system with batteries

Kit Avantgarde Plus electronic locking system with mains power

Kit Avantgarde Pro electronic locking system with mains power

& single action to escape Alarm sensor

Boltwork position sensor

Surface mounted & hidden door closer

European cylinder 1+3 keys, according to class WK4

VARIATIONS

Brass handles (polished, polished or satin chrome, bronze finish)

Bullet resistance to FB4 & FB6

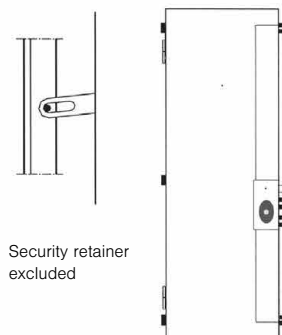

Security retainer excluded

Height between 86 and handle 95 cm compliant including Ministerial Decree 236 of 14/06/1989
Door handle height 86-95cm

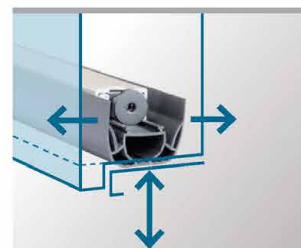

Draft excluder blade plus possible stop
Automatic door strip

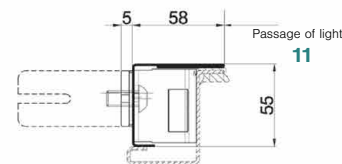

3D subframe

Notes: the handles height is between 85 and 95 cm according to D.M. 236 14/06/1989

Janus Panic

Break-in resistance class 4 EN 1627/30

Acoustic insulation -44,8 dB Rw

Thermal insulation Ud = 1.2W/m²K

Double Electrogalvanized steel structure

Thermal insulation in compressed mineral wool

Special high performance automatic doorstrip

External seal on frame, **internal seal** on leaf

Security retainer

Double oval defender in special steel class4 anti-pick rating

Security lock geared mechanism activating six bolts with self-centring rectangular latch bolt

Hinges 2 adjustables in 3 directions with same handles finish

Fixed steel bolts 3 with flat profile

Wide-angle spyhole

Veneered or melamine standard panels

Internal casing strips

External casing strips in plastified sheet RAL 9006

Brass handles (polished, polished or satin chrome, bronze finish)

Frame RAL 9006 or RAL 9010

Double european cylinder 1+3 keys, according to class WK4

Subframe 3D adjustable in 3 directions

Standard sizes: 80 to 90 x 200 to 210 cm

This model is available with different sizes from standard

OPTIONALS

Security retainer

Cylinder with mastered system

Double side key cylinder

Alarm door position sensor

Boltwork sensor

Bullet resistance to FB4 & FB6

VARIATIONS

European cylinder 1+3 keys, according to class WK4

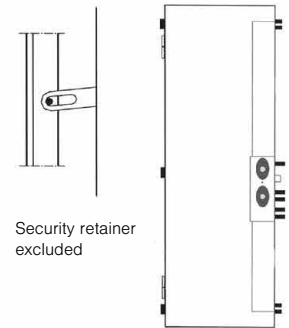

Height between 86 and handle 95 cm compliant including Ministerial Decree 236 of Id/06/1989
Door handle height 86-95cm

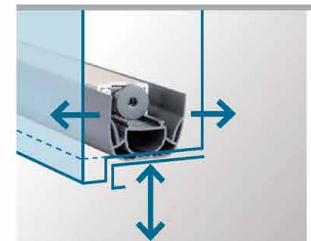

Draft excluder blade plus possible stop

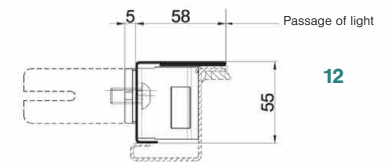

3D subframe

Janus Fire

EI₂ 60 / EI₁ 30

Break-in resistance class 3 EN 1627/30

Fire resistance 60' on both sides

Acoustic insulation -43 dB Rw

Thermal insulation Ud = 1.6W/m²K

Electrogalvanized steel structure

Thermal insulation in compressed mineral wool

Special high performance automatic doorstrip

External seal on frame, **internal seal** on leaf

Heat expanding seal

Defender in special steel class3 anti-pick rating

Security lock geared mechanism activating six bolts with self-centring rectangular latch bolt

Hinges 2 adjustables in 3 directions

Fixed steel bolts 3 with flat profile

Wide-angle spyhole

Veneered or melamine standard panels

Handles F9 finish aluminium

Internal casing strips

External casing strips in plastified sheet RAL 9006

Frame RAL 9006 or RAL 9010

European cylinder 1+3 keys, according to class WK3

Subframe 3D adjustable in 3 directions

Standard sizes: 80 to 90 x 200 to 210 cm

Size limitations: max passage size 900x2100mm, not higher dimensions allowed

OPTIONALS

Security retainer

Metal Hinge covers

Cylinder with mastered system (to add to the cost of the cylinder,

Double side key cylinder

Kit Futura for door automation (only available with external cable)

Surface mounted closer

VARIATIONS

Brass handles (polished, polished or satin chrome, bronze finish)

European cylinder 1+3 keys, according to class WK4

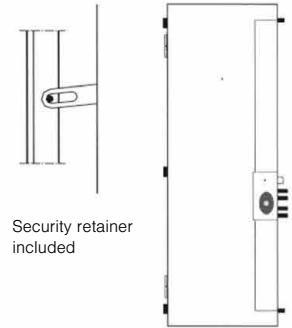

Security retainer included

Height between 86 and handle 95 cm compliant including Ministerial Decree 236 of Id/06/1989

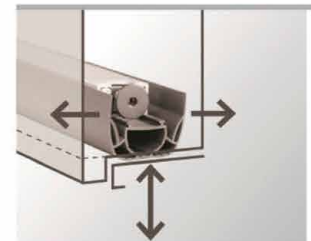

Draft excluder blade + possible stop



Hydraulic overhead door closer

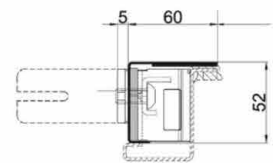

3D subframe

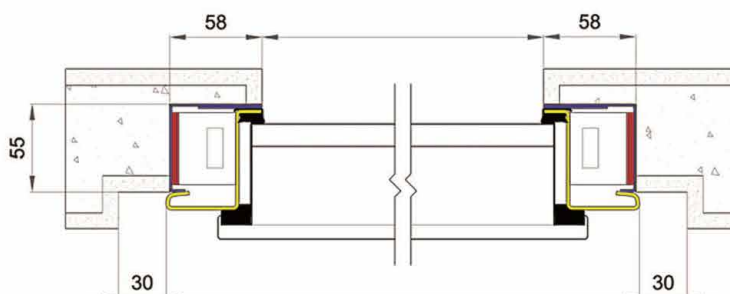

Notes: the handles height is between 85 and 95 cm according to D.M. 236 14/06/1989

Exterior Armoured Doors

Burton Security, exterior armoured doors have unparalleled quality and technological features and are the best performing on the market. They represent the perfect solution for energy-saving buildings and they come in different models and types. European burglar-resistant certifications, acoustic isolation, thermal transmittance, air, water and wind tightness.

A Janus Burton Security door embodies excellence when it seamlessly intertwines security and comfort.



Janus 3 EX

Break-in resistance class 3 EN 1627/30

Acoustic insulation -43 dB Rw

Thermal insulation Ud = 1.0W/m²K

Air tightness class 4

Water tightness class 6A

Wind load resistance class C4

Electrogalvanized steel structure

Thermal insulation in compressed mineral wool

Special high performance automatic doorstrip

Swiss threshold

External seal on frame, **internal seal** on leaf

Defender in special steel class3 anti-pick rating

Security lock geared mechanism activating six bolts with self-centring rectangular latch bolt

Hinges 2 adjustables in 3 directions with same handles finish

Fixed steel bolts 3 with flat profile

Wide-angle spyhole

Veneered or melamine standard panels

Handles F9 finish aluminium

Frame RAL 9006 or RAL 9010

European cylinder 1+3 keys, according to class WK3

Subframe 3D adjustable in 3 directions

Standard sizes: 80 to 90 x 200 to 210 cm

This model is available with different sizes from standard

OPTIONALS

Security retainer

Metal Hinge covers

Internal casing strips

External casing strips

Cylinder with mastered system

Double side key cylinder

Kit Avantgarde electronic locking system with batteries

Kit Avantgarde Plus electronic locking system with mains power

Kit Avantgarde Pro electronic locking system with mains power & single action to escape

Alarm sensor

Boltwork position sensor

Surface mounted & hidden door closer

Bullet resistance to FB4 & FB6

VARIATIONS

Brass handles (polished, polished or satin chrome, bronze finish)

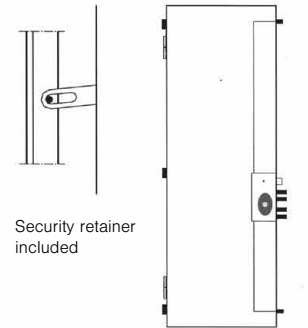

Security retainer included

Height between 86 and handle 95 cm compliant including Ministerial Decree 236 of 14/06/1989

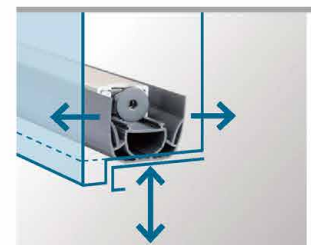

Draft excluder blade



Swiss threshold

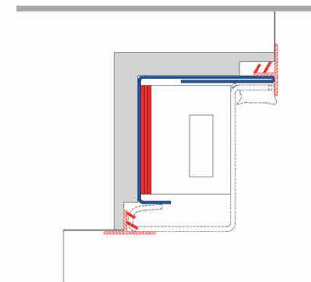

3D subframe with wraparound insulation

Janus Sunny

GLASS DOOR

Break-in resistance class 3 EN 1627/30

Acoustic insulation -43 dB Rw

Thermal insulation Ud = 1.0W/m²K

Air tightness class 4

Water tightness class 6A

Wind load resistance class C4

Electrogalvanized steel structure

Thermal insulation in compressed mineral wool

Special high performance automatic doorstrip

Swiss threshold

External seal on frame, **internal seal** on leaf

Defender in special steel class3 anti-pick rating

Security lock geared mechanism activating six bolts with self-centring rectangular latch bolt

Hinges 2 adjustables in 3 directions

Fixed steel bolts 3 with flat profile

Wide-angle spyhole

Internal panel pvc film white Ral 9016 finish with grey

External panel mineral panel with pvc film (finishes available finishes on page)

Internal Handle F9 finish aluminium

Handles F9 finish aluminium

External Handle: Tube H stainless steel fixed handle

Frame RAL 9006 or RAL 9010

Armored glass frosted finish

European cylinder 1+3 keys, according to class WK3

Subframe 3D with enveloping isolation

Standard sizes: 80 to 90 x 200 to 240 cm without surcharge

OPTIONALS

Security retainer

Metal Hinge covers

Internal casing strips

External casing strips

Cylinder with mastered system (to add to the cost of the cylinder,

Double side key cylinder

Kit Avantgarde electronic locking system with batteries

Kit Avantgarde Plus electronic locking system with mains power

Kit Avantgarde Pro electronic locking system with

mains power & single action to escape

Alarm sensor

Boltwork position sensor

Surface mounted & hidden door closer

VARIATIONS

Brass handles (polished, polished or satin chrome, bronze finish)

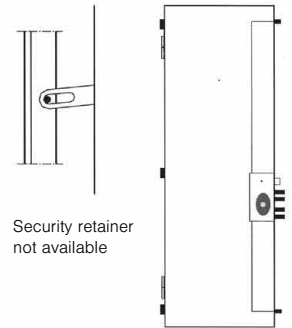

Height between 86 and handle 95 cm compliant at D.M 236 of 14/06/1989

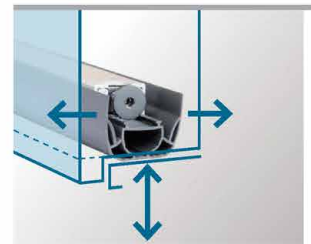

Draft excluder blade



Swiss threshold

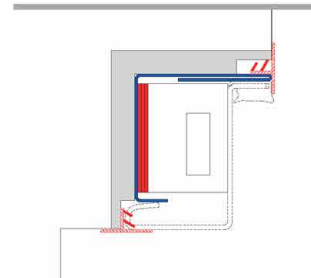

3D subframe with wraparound insulation

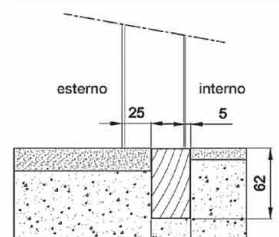

SUNNY Top Single door only
Not available with reverse armouring



For different subframes and slats ask for more info to us

Glass Doors



Minimum
dimensions
80x200cm



Maximum
dimensions
90x240cm



Visible glass 29x144cm always centred



Visible glass 20x144cm always centred

Janus 4 Ex

Break-in resistance class 4 EN 1627/30

Acoustic insulation -44,8 dB Rw

Thermal insulation $U_d = 1.2W/m^2K$

Air tightness class 4

Water tightness class 3A

Wind load resistance class C4

Electrogalvanized steel structure

Thermal insulation in compressed mineral wool

Special high performance automatic doorstrip

Swiss threshold

External seal on frame, **internal seal** on leaf

Oval Defender in special steel class4 anti-pick rating

Security lock geared mechanism activating six bolts with self-centring rectangular latch bolt

Hinges 2 adjustables in 3 directions with same handles finish

Fixed steel bolts 3 with flat profile

Wide-angle spyhole

Veneered or melamine standard panels

Internal panel casing strips

External panel mineral panel with pvc film (finishes available finishes on page)

Internal Handle casing strips in plastified sheet RAL 9006

Brass handles (polished, polished or satin chrome, bronze finish)

External Handle: Tube H stainless steel fixed handle

Frame RAL 9006 or RAL 9010

European cylinder 1+3 keys, according to class WK4

Subframe 3D Energy adjustable in 3 directions, with wood for thermal cut on the floor and perimetral insulation.

Standard sizes: 80 to 90 x 200 to 210 cm

This model is available with different sizes from standard

OPTIONALS

Security retainer

Metal Hinge covers

Internal casing strips

External casing strips

Cylinder with mastered system

Double side key cylinder

Kit Avantgarde electronic locking system with batteries

Kit Avantgarde Plus electronic locking system with mains power

Kit Avantgarde Pro electronic locking system with mains power & single action to escape

Alarm sensor

Boltwork position sensor

Surface mounted & hidden door closer

Bullet resistance FB4 & FB6

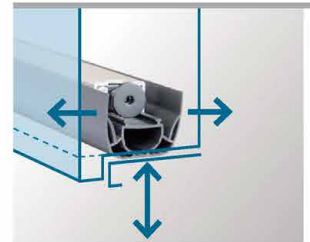
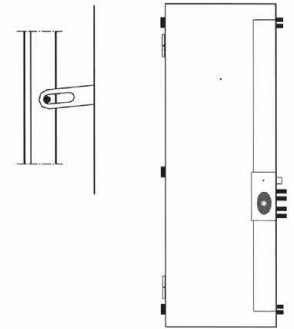

Swiss threshold

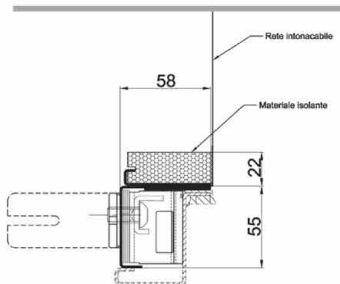

3D Energy subframe with insulation

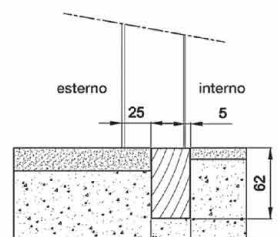

Thermic cut in the threshold



Janus Gold

Break-in resistance class 4 EN 1627/30

Acoustic insulation -46 dB Rw

Thermal insulation Ud = 0.60W/m²K

Air tightness class 4

Water tightness class 9A

Wind Resistance Class C5

Torsional resistance conforming

Impact resistance conforming

Double electrogalvanized steel structure

Thermal insulation in compressed mineral wool

Special high performance automatic doorstrip

Swiss threshold

External seal on frame, **internal seal** on leaf n°2

Oval Defender in special steel class4 anti-pick rating

Security Lock geared mechanism activating four specials bolts with self-centring rectangular latch bolt

3 Wings hinges 2 adjustables in 3 directions with same handles finish

Fixed steel bolts 3 with flat profile

Wide-angle spyhole

Veneered or melamine standard internal panel

Internal panel casing strips

Smooth multilayer wood thickness 9mm in Okoumé, Tanganika or MDF external panel

Internal and external casing strips

Stainless satin steel handles

Frame RAL 9006 or RAL 9010

European cylinder 1+3 keys, according to class WK4

Subframe 3D Energy adjustable in 3 directions, with wood for thermal cut on the floor and perimetral insulation.

Standard sizes: 80 to 90 x 200 to 210 cm

This model is available with different sizes from standard

OPTIONALS

Security retainer

Cylinder with mastered system

side key cylinder

Futura electronic locking

Alarm sensor

Boltwork position sensor

Surface mounted & hidden door closer

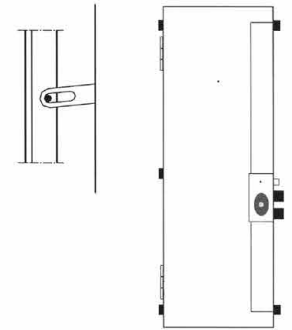

Height between 86 and handle 95 cm compliant at D.M 236 of 14/06/1989

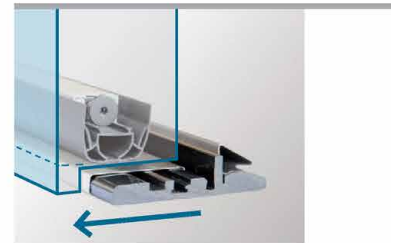

KLIMA threshold

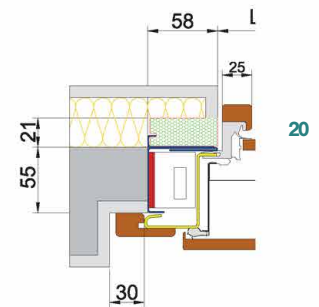

3D energy threshold

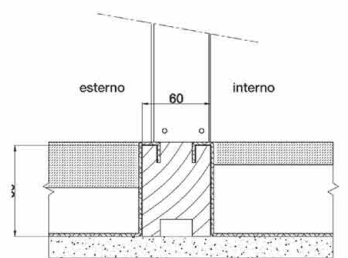

Klima thermal break under threshold



Janus Platinum

Break-in resistance class 3 EN 1627/30

Acoustic insulation -46 dB Rw

Thermal insulation Ud = 0.54W/m²K

Air tightness class 4

Water tightness class 9A

Wind load resistance class C5

Torsional resistance conforming

Impact resistance conforming

Double electrogalvanized steel structure

Thermal insulation in compressed mineral wool

Special high performance automatic doorstrip

Thermic threshold

External seal on frame, **internal seal** on leaf n°2

Oval Defender in special steel class4 anti-pick rating

Security lock geared mechanism activating four specials bolts with self-centring rectangular latch bolt

3 Wings hinges 2 adjustables in 3 directions with same handles finish

Fixed steel bolts 3 with flat profile

Wide-angle spyhole

Veneered or melamine standard internal panel

Smooth multilayer wood thickness 9mm in Okoumé, Tanganika or MDF external panel

Internal and external casing strips

Stainless satin steel handles

Frame RAL 9006 or RAL 9010

European cylinder 1+3 keys, according to class WK4

Subframe 3D Energy adjustable in 3 directions, with wood for thermal cut on the floor and perimetral insulation.

Standard sizes: 80 to 90 x 200 to 210 cm

This model is available with different sizes from standard

OPTIONALS

Security retainer

Cylinder with mastered system

side key cylinder

Futura electronic locking

Alarm sensor

Boltwork position sensor

Surface mounted & hidden door closer

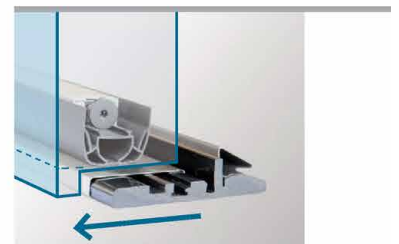
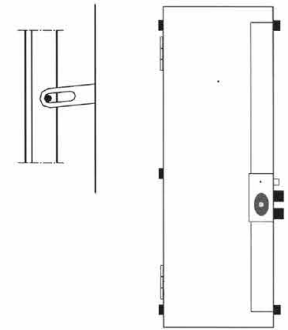

KLIMA theshold

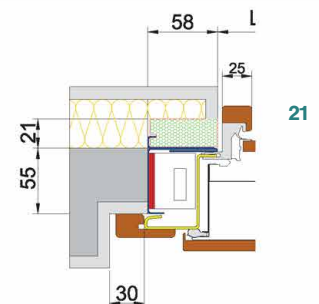

3D energy threshold

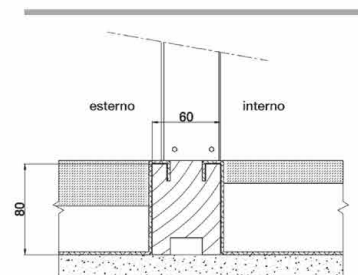

Klima thermal break under threshold



Thermic cut in the threshold

Kit Avantgarde electronic locking system

KIT AVANTGARDE



- Battery powered, stand alone version with up to 20,000 operations per set
- Mains powered version with optional battery back up
- Option for single action to escape lever handle to EN179 or push to exit button Operation by PIN code, RFID card, fingerprint & bluetooth mobile APP
- Option of wifi gateway to programme and manage remotely Up to 300 different users
- Temporary one time codes for guests and service personnel
- Timed access rights
- Full event log
- Lock status monitoring Automatic locking on closure

NB Not compatible with Panic, Fire & Klima models.

22



Lock with "Single Action" function which allows the release of all throws by lowering the handle.



Backlit numeric keypad. External opening command via numerical code and transponder and bluetooth control.



Special flat deadbolts to optimize closing and latchbolt with double slope to guarantee correct coupling and the absence of vibrations during closing.



Contacts for electronic lock.



Electronic peephole with built-in camera, optional.



Coloured Glass



24



Burton Security

Standard Panels

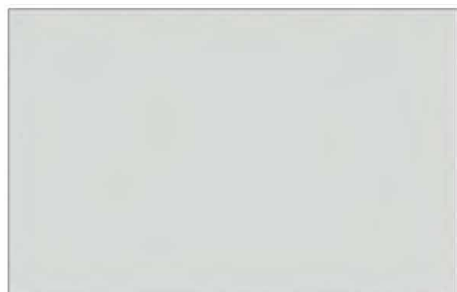

MDF laccato Ral 9 mm



Tanganika naturale 9 mm
Tanganika naturale 14 mm



Tanganika chiaro 9 mm
Tanganika chiaro 14 mm



Tanganika medio 9 mm
Tanganika medio 16 mm



Tanganika scuro 9 mm
Tanganika scuro 14 mm



Okumè naturale 9 mm
Okumè naturale 14 mm

25



Okumè chiaro 9 mm
Okumè chiaro 14 mm



Okumè medio 9 mm
Okumè medio 14 mm



Okumè scuro 9 mm
Okumè scuro 14 mm



Rovere naturale 14 mm



Rovere chiaro 14 mm



Rovere medio 14 mm

Standard Panels



Rovere scuro



Douglass naturale



Douglass chiaro



Douglass medio



Douglass scura



Yellow Pine nat.

26



Yellow Pine chiaro 16 mm



Yellow Pine medio

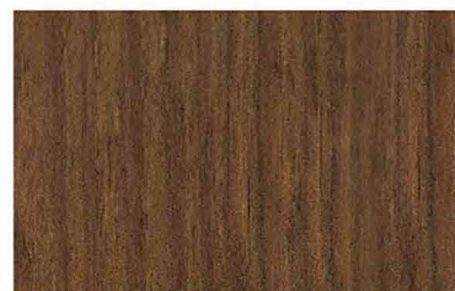

Yellow Pine scuro



Larice naturale



Larice chiaro



Larice medio

Standard Panels



Larice scuro



Faggio naturale



Faggio chiaro



Faggio medio



Faggio scuro



Abete naturale

27



Abete chiaro



Abete medio



Abete scuro



Ciliegio naturale



Ciliegio chiaro



Ciliegio medio

Types of Pantographed Panels



F1 - di serie se non è specif. la sez.



F2



FS3



F3



F4



FS5



F5



FR



FS6



FS1



FS4



FS7



FS10 - Finitura d'acciaio da 7mm



FS8 - Tondo da 6mm in acciaio



FS9 - Tondo da 12mm in acciaio

Types of Pantographed Panels



P0



P1



P3



P5



P9



P11



P13



P15



P17



P19



P21



P23

Types of Pantographed Panels



P24



P25



P27



P29



P31



P33



P35



P37



P39



P41



P43



P45

Types of Pantographed Panels



P47



P49



P51



P53



P55



P57



P59



P61



P63



P65



P67



P69

Types of Pantographed Panels



P71



P73



P75



P77



P79



P81



P83



P85



P87



P89



P91

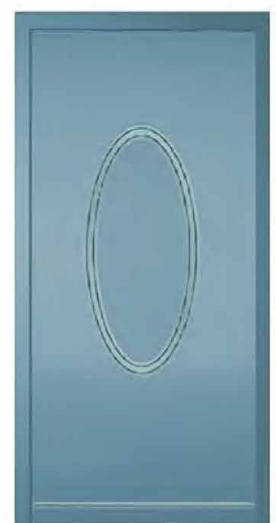

P93

Types of Pantographed Panels



P95



P97



P99



P101



P103



P105



P107



P109



P111



P113



P115



P117

Types of Pantographed Panels



P119



P120 S



P120 D



P121 S

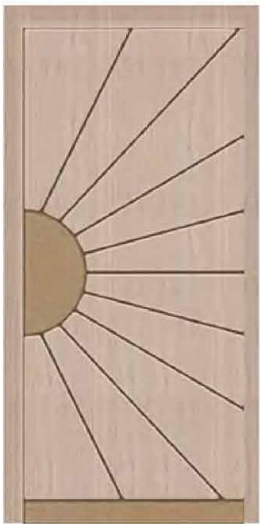

P121 D



P122



P151



P152

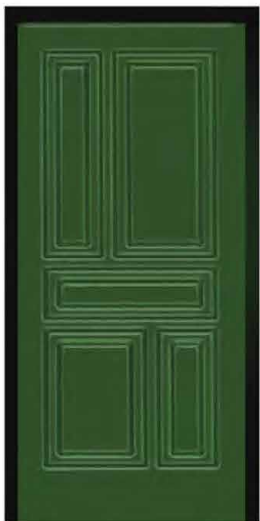

P154



P155



P156



P157

Types of Pantographed Panels



P158



P159



P160



P161



P162



P164



P165



P166



P167



P168



P169



P170

Types of Pantographed Panels



P171



P172



P173



P174



P175



P176



P177



P178



P179



P180



P181



P182

Types of Pantographed Panels



P183



P184



P196



P197



DS10



DS01- D DS01- S



DS02



DS03



DS04



DS06



DS07



DS08

Types of Pantographed Panels



DS09



DS010



DS011



DS012



DS013



DS014

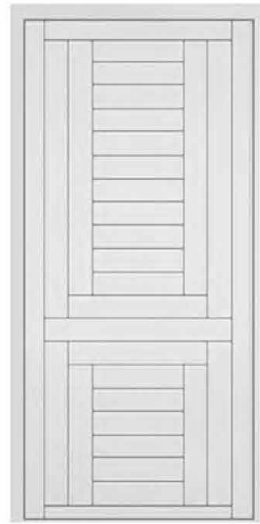

P177-2



DS015



DS016



DS017



DS018



DS019

Types of Pantographed Panels



DS020



DS021



DS022



DS023



NE



NF



NG



NH



NI



NL



NM



NB

Types of Pantographed Sunny



NQ



PV6



PV7



PV17L



PV17P



PV17R



PV19P



PV23



PV24



PV25



PV29



PV31

Types of Pantographed Sunny



PV33



PV35



PV39



PV45L



PV47



PV51L



PV52

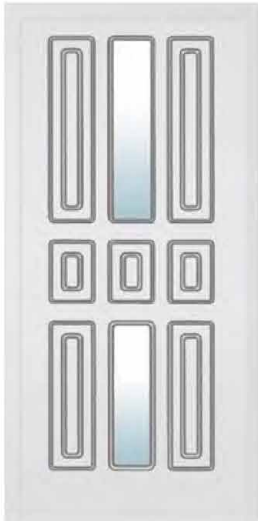

PV57



PV58



PV85



PV87



PV91P

Types of Pantographed Sunny



PV93



PV97L



PV101



PV107



PV109L



PV111L



PV113P



PV115



PV117



PV119P



PV121



PV122

Types of Pantographed Sunny



PV124



PV125



PV126



PV127



PV128



PV129



PV130



PV131

43



PV132



PV133



PV134



PV135

Types of Pantographed Sunny



PV136



PV138



PV139



PV140



Pv141



PV142



PV143



PV144



PV145



PV146



PV151



PV158

Types of Pantographed Sunny



PV161



PV162



P184



PV173 D/S



PV175



PV176



PV120



PV163 D/S

45



PV164



PV147



PV148



PV149

Types of Pantographed Sunny

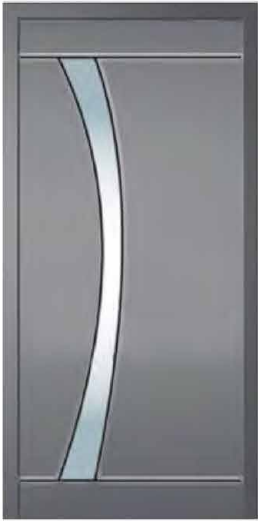

PV150



PV177

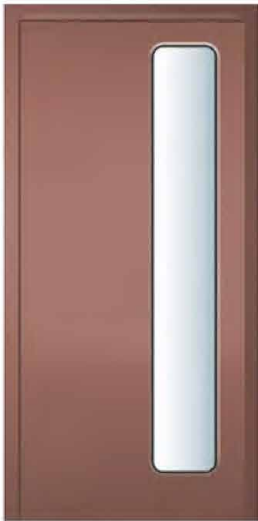

P178



PV179



PV179-2



PV180

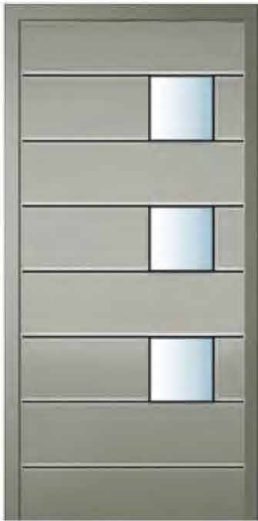

PV181

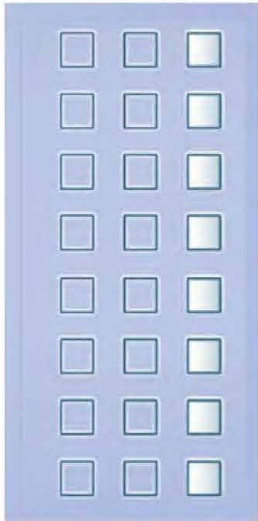

PV182

46



PV183



PV184

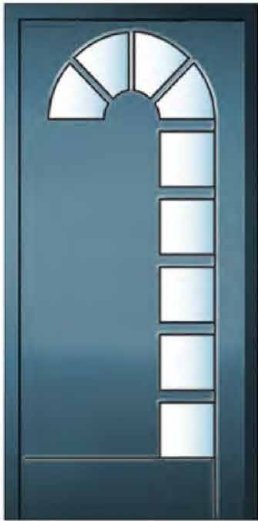

PV185



PV186

Types of Pantographed Arco Panels

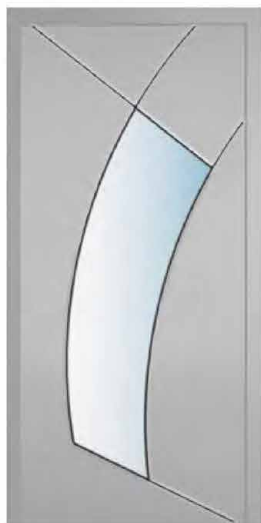

PV187



AP159



AP161



AP52



AP162



AP19



AP160



AP190



AP105



AP107

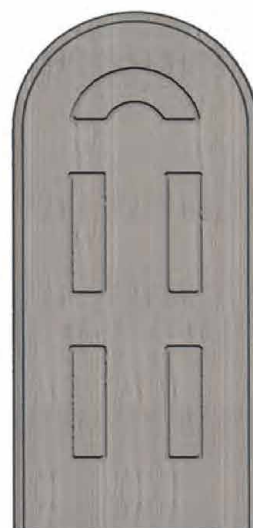

AP123



AP109

Types of Pantographed Arco Panels



AP184



AP185



AP75



AP89



AP67



AP69



AP170

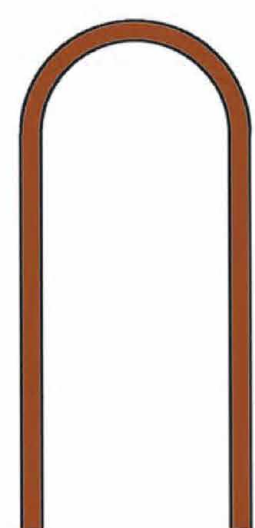

CORNICI INT. 50X18

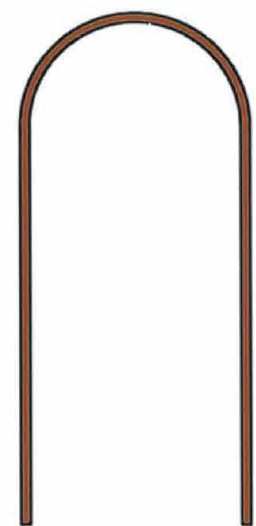

CORNICI EST. 30X12

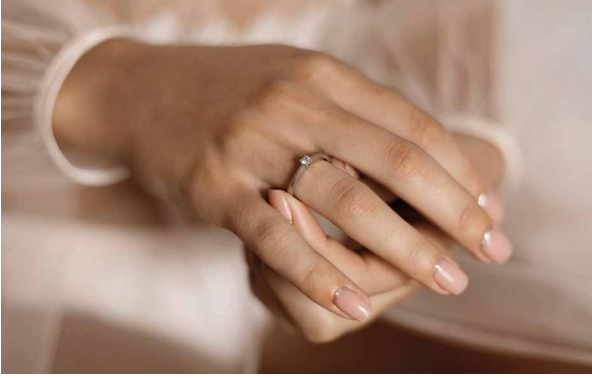

PREMIUM
SECURITY & HIGH
PERFORMANCE
DOORS

Janus Armoured Security and Fire Doors

Brockholes Business Park,
Rock Mill Road, Brockholes,
Holmfirth, HD9 7BN

T. +44 01484 663388

www.burtonsecurity.com
enquiries@burtonsecurity.com

